



BK7-EXLO

Spring Bale Opener

The BK7-EXLO spring bale opener is designed to safely decompress spring units.

New laydown arms can be loaded upright from an expeditor vehicle and then safely lowered into position on the base of the unbaler. This safe and ergonomic feature improves employee safety and productivity.

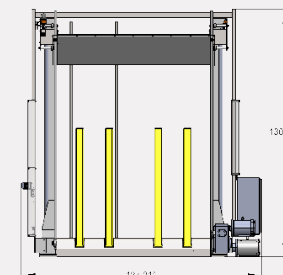
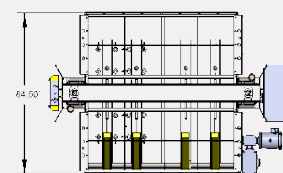

SPECIFICATION	BK7-EXLO
Electrical:	230 Volt, 60 Hz, 3 phase, 26 AMP
Electrical Motor:	5 HP (3.7 Kw)
Overall Height:	130" (330 cm)
Working Height:	105" (267 cm)
Floor Area Required:	87" x 130" (221 cm x 330 cm)
Crate Size/Domestic:	114" x 86" x 31" (290 cm x 219 cm x 79 cm)
Weight:	2,500 lbs. (1,135 kg)
Crate Size/Ocean:	115" x 87" x 32" (291 cm x 221 cm x 81 cm)
Weight:	2,600 lbs. (1,181 kg)

Designed for today's coil specifications, the BK7-EXLO unbaler will safely handle innersprings with higher coil counts, heavier wire gauge, and new coil designs. The BK7-EXLO is rated at the industry standards of 18,000 lbs. (8,175 kg) opening pressure and the screw-drive rating in excess of 36,000 lbs. (16,350 kg).

- Safety rating of 18,000 lbs. (8,175 kg)
- 2-1/4" Acme screw-drive system eliminates replacing drive chains
- Simple and reliable bale opening for any size bale; including twin, queen, and king size
- Built-in Lay-down Arms to safely invert compressed bails.
- Self-oiling system keeps screw-drive moving parts in good working order.
- Welded grid members on the top of the platform and additional guards around the edges aid in protecting the operator from flying debris
- Two-speed opening rate reduces risk of entangling coils during decompression
- Two-button controls on the control box must be held down during operation, keeping the operator safely away from the bale and other moving parts during opening
- 102" (259 cm) opening height from platform base to upper platen
- Safety rods to stabilize narrow innersprings and corner guides prevent deformation of border rods during opening
- Meets all OSHA and CE safety directives

Gribetz® is the world's leading mattress machinery manufacturer with over a century of experience in machine design. Through rigorous stress and strain analyses, and 3D modeling, our engineering team prides itself in building the most durable state of the art machinery in the industry. We specialize in manufacturing high tech computerized quilting machines, panel cutters, automated and conventional sewing machines, material handling solutions, and mattress-packaging equipment. Call for more information today!

800-326-4742 • 954-846-0300 • Gribetz.com



131 Zapletal Way
Carthage, MO 64836 USA

